



F092
SERVICE BULLETIN

MAY 07

RELOCATION OF DECK IDLER SPRING ANCHOR TO PREVENT POTENTIAL DECK BELT KICK-OFFS.

MODELS AFFECTED			EXPORT MODELS ONLY
Brands	Model Nos.:	Serial No. Range:	Description:
Ferris	5900627	2000698870 - 2000783910	IS2000Z, 20HP Export Zero-Turn Riding Mower w/ 48" Side Discharge Deck
	5901192	2000698870 - 2000783910	IS2000Z, 20HP Export Zero-Turn Riding Mower w/ 48" Rear Discharge Deck
Simplicity	5901187	2000698870 - 2000783910	IS2000Z, 20HP Export Zero-Turn Riding Mower w/ 48" Side Discharge Deck
	5901188	2000698870 - 2000783910	IS2000Z, 20HP Export Zero-Turn Riding Mower w/ 48" Rear Discharge Deck

DETAIL

Field reports indicate that models listed in the serial number range above need to relocate the deck idler spring anchor to prevent potential deck belt kick-offs.

CORRECTIVE PROCEDURES

1. Park the machine on a flat, level surface and engage the parking brake. Disengage the PTO switch, turn off the engine and remove the key from the ignition.

⚠ WARNING

Use extreme caution when rotating the idler arm with the breaker bar, due to the increased tension in the spring as the idler arm is being rotated. Injury may result if the breaker bar is prematurely released while the spring is under tension.

2. Using a 1/2" breaker bar, place the square end in the square hole located in the end of the idler arm (A, Figure 1). Carefully rotate the breaker bar counter-clockwise, which will relieve the tension on the belt exerted from the idler arm.
3. Slide the drive belt over the edge of the stationary idler pulley (B). Carefully release the tension on the breaker bar until the idler arm stops against the center spindle pulley.
4. Remove the belt and set aside for reinstallation later.

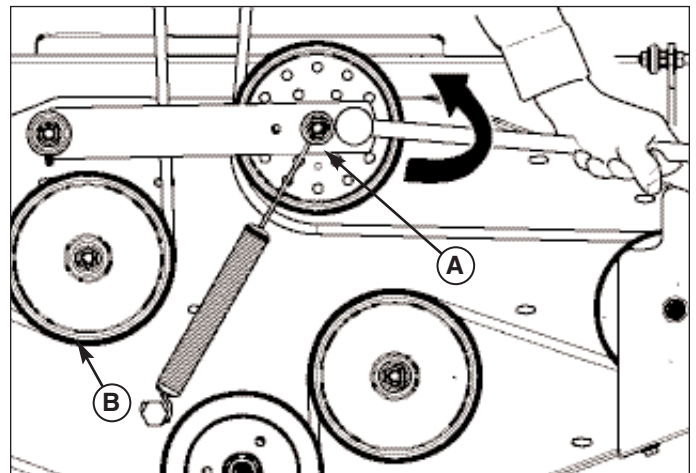

Figure 1. Mower PTO Belt
A. Idler Arm
B. Stationary Idler Pulley

5. Loosen and remove the 1/2-13 hex nylock flange nut (C, Figure 2) that secures the spring anchor bolt assembly (A) to the mower deck.
 6. Remove the spring anchor bolt assembly from the hole in the mower deck and rotate away from the hole.
 7. Refer to Figure 3. From the center of the hole that the spring anchor bolt assembly was removed from measure .71" (1,8 cm) to the right. Mark this area.
 8. Measure .71" (1,8 cm) from the mark that was made in Step 7 towards the front of the deck. Mark this area.
 9. Using a 1/2" (13 mm) drill bit, drill a hole in the area that was marked in Step 8.
 10. Install the spring anchor bolt assembly into the new hole and secure with the 1/2-13 hex nylock flange nut removed in Step 5.
 11. Reinstall the belt. Make sure the V-side of the belt runs in the pulley grooves (Figure 4).
5. Install the drive belt on the PTO pulley, the spindle pulleys and all idler pulleys except the stationary pulley (D, Figure 4). Carefully rotate the breaker bar counter-clockwise and install the belt on the stationary idler pulley (D). Carefully release the tension on the breaker bar.

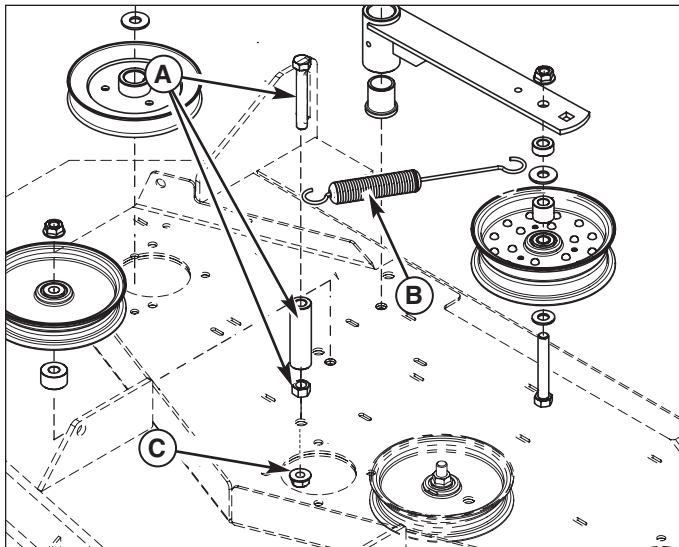

Figure 2. Removing the Spring Anchor
A. Spring Anchor Bolt Assembly
B. Idler Spring
C. 1/2-13 Hex Nylock Flange Nut

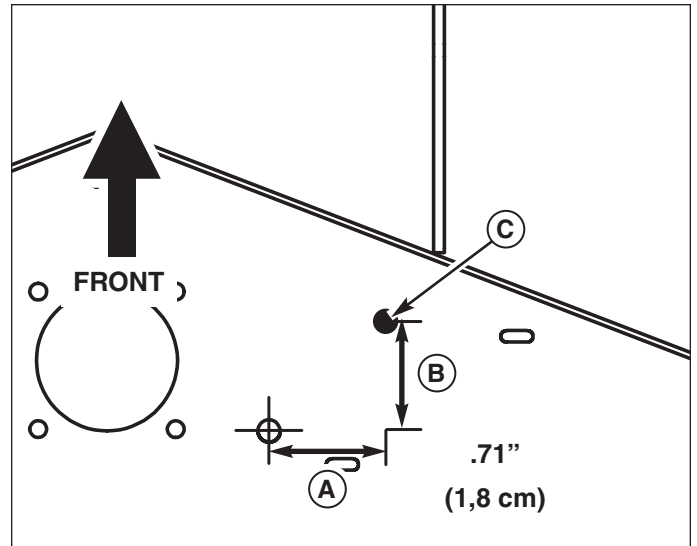

Figure 3. Drilling the New Hole for the Spring Anchor Bolt
A. First Measurement .71" (1,8 cm)
B. Second Measurement .71" (1,8 cm)
C. New Hole Position

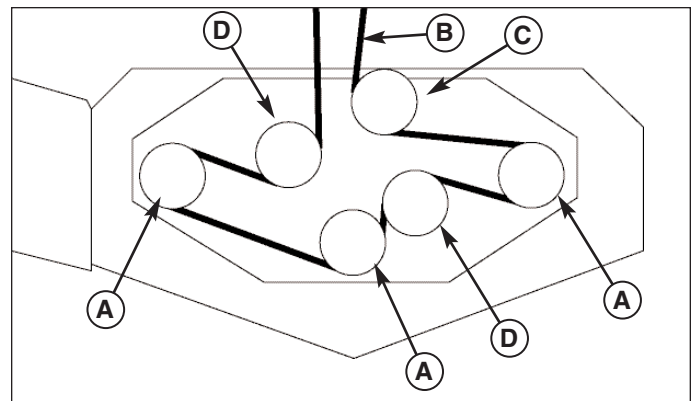

Figure 4. Mower PTO Belt Routing
A. Spindle Pulley
B. PTO Drive Belt
C. Spring-loaded Idler Pulley
D. Stationary Idler Pulley

WARRANTY INFORMATION

Fill in the Warranty Claim Form with the following information.

Failure Location Category:	L&G Body/Chassis
Failure Location Code:	F72
Defect Code / Failure Mode	PM
Control / Evaluation No.:	F092
Pickup & Delivery:	N/A
Total Hours:	0.5

Cause of Failure:	N/A
Work Performed:	F092
Repair Parts:	N/A