



Checking the Hydraulic Pump Drive Pulley Hardware on IS5100Z Models

Ferris has determined that the hardware securing the hydraulic pump drive pulleys may not have been tightened to the correct torque specifications on the units detailed below. This details a procedure for inspecting the hardware and tightening the hardware if necessary.

MODEL NUMBER	DESCRIPTION	SERIAL NUMBER RANGE
5901282	IS5100ZC33D72	2016929289 - 2016937279
5901283	IS5100ZC33D72RD	2016929289 - 2016937279

Checking the Torque of the Pulley Hardware:

1. Park the unit on a flat, level surface such as a concrete floor. Disengage the PTO, engage the parking brake, turn the ignition switch to OFF, and remove the key from the ignition.
2. Release the hood latch and raise the hood until it locks in place.
3. Remove the rear belt shield.
4. Using a 7/16" socket and a torque wrench, set the wrench to 120 in. lbs. (13.5 Nm) and check the torque of the two 1-4" bolts (**A, Figure 1**) on both tapered hub bushings (**B**) that secure the hydraulic pump drive pulleys (**C**).
5. If the bolts need tightening, alternate tightening the bolts back and fourth until you reach the correct torque specification.

NOTE: The hydraulic pump drive pulleys (**C**) should be spaced approximately 5/16" off of the pump plate (**D**).

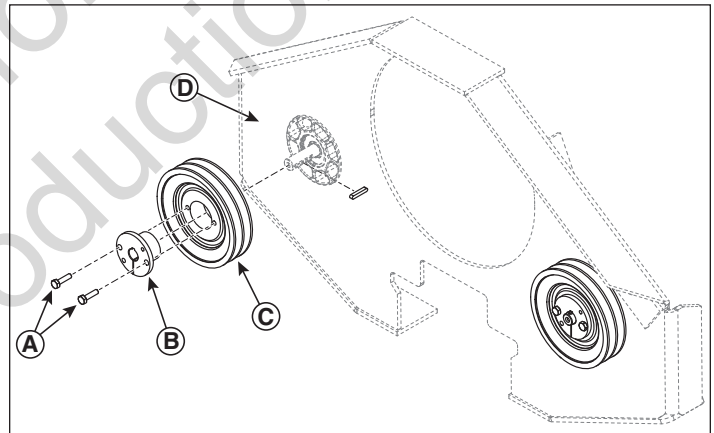

Figure 1. Checking the Torque of the Pulley Hardware
A. 1/4-20 x 1" Bolt
B. Tapered Hub Bushing
C. Hydraulic Pump Drive Pulley
D. Pump Plate Weldment

**** You can find ALL of our Product Information Sheets on The Power Portal.**